

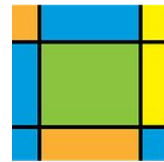

Bartlett Public Library District

Community Engagement



BARTLETT
Public Library District



For more than 50 years, the Bartlett Public Library has been the best place in our community for residents to come together to learn and discover.



Our library has a special hometown feel where everyone is welcome, an environment fostered by our amazing staff who go above and beyond to help each person who comes through our doors.

Our entire community has a say in helping make this a special place where there is something for everyone to enjoy.



We're not just books—from programs and events to quiet study areas, from computers to games, from play areas to an art room, we are truly a community center.

In fact, despite being a smaller library, we offer a significant number of programs including the most young adult programs per capita of any library in the region.



The feedback from our community is positive, giving high marks for our helpful staff, quality programming, and central location.



In fact, our library has such a great reputation that many residents from surrounding communities prefer coming to our library because of the level of service we provide and the programming we offer.

It's proof we are doing something right, even if it does sometimes require us to limit programming to Bartlett residents to make sure we are prioritizing our community's families.



We've accomplished this while remaining one of the most fiscally responsible library districts in the region.

We've eliminated the budget deficit and have maintained a balanced budget for the past six years.

We spend the public's tax dollars conservatively, ensuring every dollar we spend goes towards things our patrons are requesting and keeping our building safe and maintained.

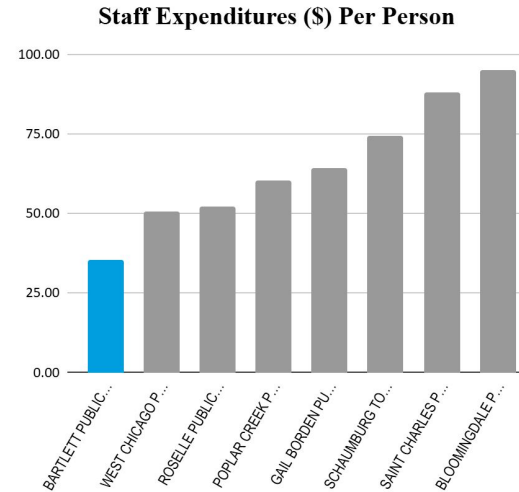
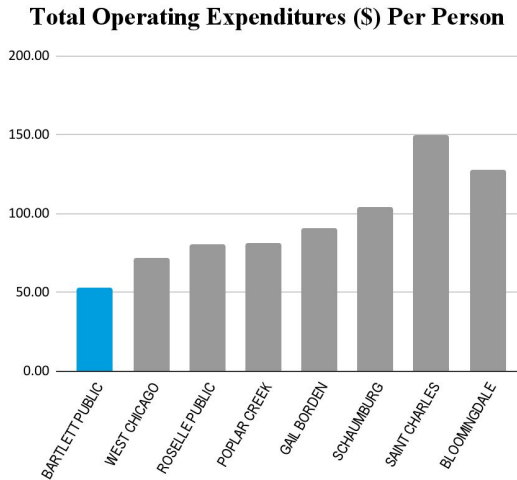

We seek out donations and utilize resources and equipment from other libraries.

As a result, compared to our neighboring library districts,
we spend the least per person we serve with the lowest staff expenses.



However, our facilities are aging and we don't currently have the funding to address the major improvements desired by the community.

Built in 1983 with two later additions, the outdated building and antiquated furniture keeps our library from being the inviting community space it could be.

Lack of space is a significant concern, limiting our program offerings and registration while our quiet spaces and study rooms are consistently overbooked, youth spaces are inadequate, and we don't have room to expand our collection of books and AV materials.

The community is requesting updated technology and access to more STEM and Career & Technical Education (CTE) programming.



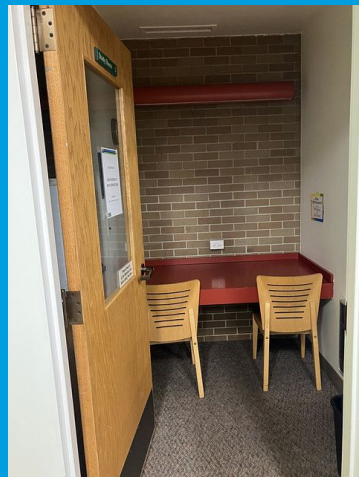

Our private rooms aren't as private as they could be.

The building requires accessibility improvements and a more efficient layout.

Our heating and air conditioning mechanical systems are deteriorating, and with eight different units trying to maintain our library, we are frustratingly inefficient.

Not only do these challenges hold our library back, but they also make it harder to retain our quality staff. It is putting at risk what makes our library special.



That's why our community has come together to collaborate on a long-term solution that responsibly addresses our infrastructure and space challenges, increases our efficiency and sustainability, and raises property values for everyone in the community.

Please continue to participate in these community engagement activities throughout the remainder of 2025.

Community Engagement 2025

During this latest phase of community engagement, we will:

- Host the first Community Committee meeting.
- Hold 4 public engagement sessions (3 in-person and 1 virtual).
- Actively gather responses from the community via as many platforms as possible.

Community Engagement 2025

Now, it's time to gather your opinions about:

- 11 Potential Individual Projects.
- 3 Potential Infrastructure Solutions.

Potential Individual Projects

- Programming Spaces
- Study Rooms & Quiet Spaces
- Building Layout & Accessibility
- Technology
- Drive-Up Window
- Youth Spaces
- Books & Shelving
- Meeting Spaces
- Outdoor Spaces
- Adult & Teen Spaces
- Sustainability



Programming Spaces

Advantages:

- Additional and larger spaces for programming activities, allowing for more programming to fulfill the community's wishes as well as increased capacity to meet community demand.

Disadvantages:

- Cannot achieve without major renovation or new construction.

Estimated Cost: \$1.5 million



Study Rooms & Quiet Spaces

Advantages:

- Additional rooms and spaces to allow library patrons to read, learn, work, and relax in a quiet, peaceful atmosphere.

Disadvantages:

- Cannot achieve without major renovation.

Estimated Cost: \$600,000



Building Layout & Accessibility

Advantages:

- More efficient library layout including relocating service desk and staff closer to the front entrance as well as improved building accessibility including investments in entrances, restrooms, and the elevator.

Disadvantages:

- Costly due to maintenance needs in older building.

Estimated Cost: \$2.5 million



Technology

Advantages:

- Dedicated STEM and Career & Technical Education spaces with improved access to technology, including a makerspace, to allow for hands on learning and the opportunity to explore new ideas and potential careers.

Disadvantages:

- Cannot achieve without expansion or new construction as well as additional staff.

Estimated Cost: \$750,000



Drive-Up Window

Advantages:

- New drive-up window allowing patrons to drop off and renew items conveniently from the comfort of their vehicle, which is helpful to seniors and parents with young children.

Disadvantages:

- Cannot achieve without expansion and reconfiguration of existing site.

Estimated Cost: \$800,000.



Youth Spaces

Advantages:

- Improved spaces specifically designed for children, including larger story time and crafting rooms and a larger play space with innovative toys to encourage kids to explore, play, and be creative in a safe environment.

Disadvantages:

- Cannot achieve without expansion or new construction.

Estimated Cost: \$4.5 million



Books & Shelving

Advantages:

- Additional and improved shelving to allow the district to expand its collection of books and audiovisual materials that is currently maximized due to space constraints and lack of shelving.

Disadvantages:

- Potential loss of meeting space.

Estimated Cost: \$200,000



Meeting Spaces

Advantages:

- Additional and larger meeting spaces to meet the demand from community organizations looking for meeting space in our community.

Disadvantages:

- Cannot achieve without major renovation or new construction.

Estimated Cost: \$900,000



Outdoor Spaces

Advantages:

- Dedicated spaces on library grounds with permanent seating to allow for outdoor programming for all ages with potential for enclosing the courtyard to make it an indoor/outdoor educational and programming space.

Disadvantages:

- Potential loss of green space.

Estimated Cost: \$300,000 to \$1.2 million

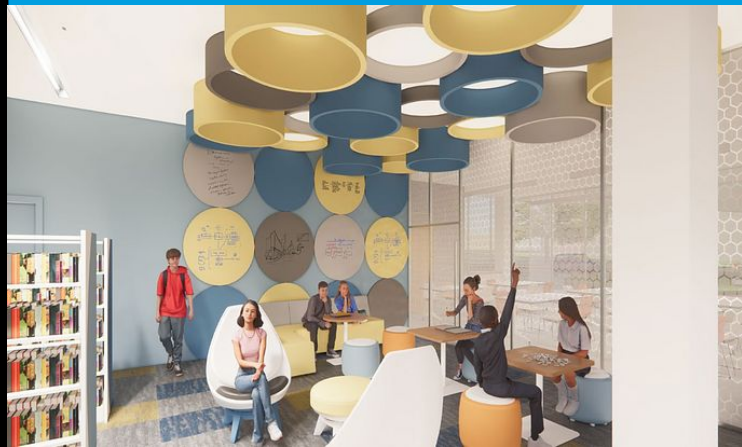

Adult & Teen Spaces

Advantages:

- Additional quiet and collaborative spaces for adults and teens to meet the high demand for space.

Disadvantages:

- Cannot achieve without expansion or new construction.

Estimated Cost: \$4.65 million



Sustainability

Advantages:

- Investments in renewable energy such as solar roof panels, electric vehicle charging stations, and geothermal heating and cooling systems to sustainably power the library and gain LEED certification.

Disadvantages:

- Costly due to outdated facilities.

Estimated Cost: \$650,000

Potential Individual Projects

Discussion

- Programming Spaces
- Study Rooms & Quiet Spaces
- Building Layout & Accessibility
- Technology
- Drive-Up Window
- Youth Spaces
- Books & Shelving
- Meeting Spaces
- Outdoor Spaces
- Adult & Teen Spaces
- Sustainability

Feedback Form

Procedures

- Rank By Highest Priority (1=Highest, 11=Lowest)
- Must Rank All Projects
- Rankings Can Only Be Used Once, No Ties

We Cannot Count Your Rankings If You Do Not Follow
the Above Procedures!

Feedback Form

| RANK | POTENTIAL INDIVIDUAL PROJECTS |
|------|---|
| | PROGRAMMING SPACES: Additional and larger spaces for programming activities, allowing for more programming to fulfill the community's wishes as well as increased capacity to meet community demand. <i>(Estimated Cost: \$1.5 million)</i> |
| | STUDY ROOMS & QUIET SPACES: Additional rooms and spaces to allow library patrons to read, learn, work, and relax in a quiet, peaceful atmosphere. <i>(Estimated Cost: \$600,000)</i> |
| | BUILDING LAYOUT & ACCESSIBILITY: More efficient library layout including relocating service desk and staff closer to the front entrance as well as improved building accessibility including investments in entrances, restrooms, and the elevator. <i>(Estimated Cost: \$2.5 million)</i> |
| | TECHNOLOGY: Dedicated STEM and Career & Technical Education spaces with improved access to technology, including a makerspace, to allow for hands on learning and the opportunity to explore new ideas and potential careers. <i>(Estimated Cost: \$750,000)</i> |
| | DRIVE-UP WINDOW: New drive-up window allowing patrons to drop-off and renew items conveniently from the comfort of their vehicle, which is helpful to seniors and parents with young children. <i>(Estimated Cost: \$800,000)</i> |
| | YOUTH SPACES: Improved spaces specifically designed for children, including larger story time and crafting rooms and a larger play space with innovative toys to encourage kids to explore, play, and be creative in a safe environment. <i>(Estimated Cost: \$4.5 million)</i> |
| | BOOKS & SHELVING: Additional and improved shelving to allow the district to expand its collection of books and audiovisual materials that is currently maximized due to space constraints and lack of shelving. <i>(Estimated Cost: \$200,000)</i> |
| | MEETING SPACES: Additional and larger meeting spaces to meet the demand from community organizations looking for meeting space in our community. <i>(Estimated Cost: \$900,000)</i> |
| | OUTDOOR SPACES: Dedicated spaces on library grounds with permanent seating to allow for outdoor programming for all ages with potential for enclosing the courtyard to make it an indoor/outdoor educational and programming space. <i>(Estimated Cost: \$300,000 to \$1.2 million)</i> |
| | ADULT & TEEN SPACES: Additional quiet and collaborative spaces for adults and teens to meet the high demand for space. <i>(Estimated Cost: \$4.65 million)</i> |
| | SUSTAINABILITY: Investments in renewable energy such as solar roof panels as well as more environmentally friendly features such as energy-efficient boilers, HVAC equipment and a green roof. <i>(Estimated Cost: \$650,000)</i> |

Feedback Form

Please scan the QR code to complete the feedback form.

Only complete the top section of the form by ranking the Individual Projects.



Potential Infrastructure Solutions

- Renovation
- Additions + Renovation
- New Library

Renovation

Advantages:

- Least expensive option.
- Essential infrastructure work can be completed.

Disadvantages:

- Maintenance and infrastructure costs will increase exponentially as building continues to age.
- Nearly all improvements desired by the community cannot be achieved.

Estimated Cost: \$9.2 million

Approximate Average Tax Impact: \$68/yr*

**Based on average \$400,000 home in the district.*

Additions + Renovation

Advantages:

- Essential infrastructure work can be completed.
- Many improvements desired by the community can be achieved through additions and significant renovations.

Disadvantages:

- Maintenance and infrastructure costs will increase exponentially as building continues to age.
- Some improvements desired by the community cannot be achieved.

Estimated Cost: \$16.3 million

Approximate Average Tax Impact: \$120/yr*

**Based on average \$400,000 home in the district.*

New Library

Advantages:

- Brand new library building for the community.
- Long-term operational and maintenance savings.
- All major improvements desired by the community can be achieved.

Disadvantages:

- Most expensive option.

Estimated Cost: \$32.5 million

Approximate Average Tax Impact: \$239/yr*

**Based on average \$400,000 home in the district.*

Potential Infrastructure Solutions Discussion

- Renovation
- Additions + Renovation
- New Library

Feedback Form

| RANK | POTENTIAL INFRASTRUCTURE SOLUTIONS |
|------|---|
| | RENOVATION: Funds Essential Infrastructure Work \$9.2million Avg Tax Impact: \$68/yr* |
| | ADDITIONS + RENOVATION: Essential Infrastructure Work Plus Additions to Increase Space \$16.3 million Avg Tax Impact: \$120/yr* |
| | NEW LIBRARY: New Library Building \$32.5 million Avg Tax Impact: \$239/yr* |
| | I Do Not Support Additional Funding for Our Library |

**Based on average \$400,000 home in the district.*

Feedback Form

Please return to the feedback form and rank the Potential Infrastructure Solutions.



**Thank you for being part of this
community-driven collaboration.**

Together, we will inspire curiosity in every member of our community, bringing them into our library where they can learn, discover, and build relationships with each other.

